

**Joelho 45° PVC-U**

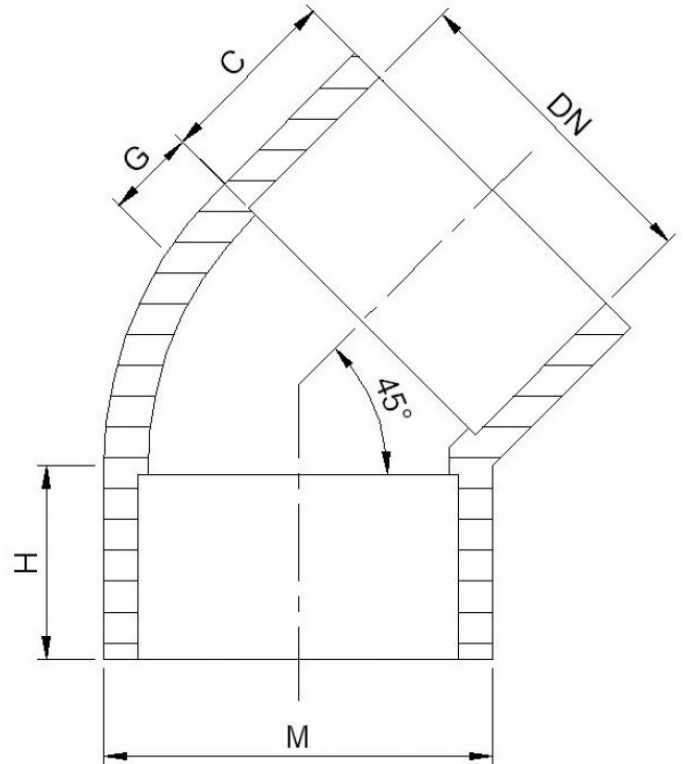

| DN (pol)  | Código | C     | M     | H     | G    | Peso Aprox. (kg)    |
|-----------|--------|-------|-------|-------|------|---------------------|
| DN (inch) | Code   | C     | M     | H     | G    | Weight Approx. (Kg) |
| 1/2"      | 817005 | 22.3  | 29.5  | 30.4  | 7.9  | 0.05                |
| 3/4"      | 817007 | 25.9  | 35.8  | 34.3  | 8.4  | 0.07                |
| 1"        | 817010 | 29.1  | 49.9  | 37.4  | 8.3  | 0.10                |
| 1.1/4"    | 817012 | 28.6  | 52.8  | 42.1  | 10.0 | 0.16                |
| 1.1/2"    | 817015 | 35.2  | 59.3  | 45.4  | 10.2 | 0.18                |
| 2"        | 817020 | 38.2  | 72.2  | 50.8  | 12.6 | 0.31                |
| 2.1/2"    | 817025 | 44.6  | 89.7  | 62.9  | 18.3 | 0.49                |
| 3"        | 817030 | 47.8  | 105.4 | 68.6  | 20.7 | 0.64                |
| 4"        | 817040 | 57.4  | 132.9 | 78.6  | 21.2 | 1.16                |
| 6"        | 817060 | 76.9  | 194.3 | 116.2 | 39.2 | 4.24                |
| 8"        | 817080 | 102.6 | 247.6 | 158.7 | 56.1 | 5.04                |
| 10"       | 817100 | 139.7 | 304.8 | 205.9 | 66.2 | 9.07                |

**Obs.:** Todas medidas acima estão em milímetros (mm) , salvo indicação contrária.